

# Intersection of Social Vulnerability and Resilience to Extreme Weather and Other Disasters- the Equitable Resilience Builder (ERB)

*Keely Maxwell (ORD)*

*For the Equitable Resilience Builder Team: Brittany Kiessling, Emily Eisenhauer, Meridith Fry, Susan Julius (ORD), Marissa Matsler (ORISE), Jeanine Finley (OW)*

*Disclaimer: This document has been reviewed in accordance with U.S. Environmental Protection Agency policy and approved for publication.*

# Research Problem the ERB Addresses

**Disasters** can create or worsen environmental and health problems.

**Communities** need to address multi-hazard, multi-sectoral risks.

**Community resilience** work needs to systematically and deliberately address social vulnerability and inequities.



# Equitable Resilience Builder Team Focuses on Solving Part of this Problem

## How might we help..

Personnel from underresourced jurisdictions



Inclusively assess vulnerability & resilience



To carry out equitable planning & actions



# ERB Is a Multi-hazard, Multi-sector Tool for Local Jurisdictions to Self-assess Disaster & Climate Resilience



# ORD Partnership with Urban Waters (UW)

Equitable Resilience  
Builder (ERB) will:

- Provide information for local resilience planning
- Demonstrate value of place-based partnerships
- Develop approach to analyze social vulnerability



# Human-centered design (HCD) of the ERB

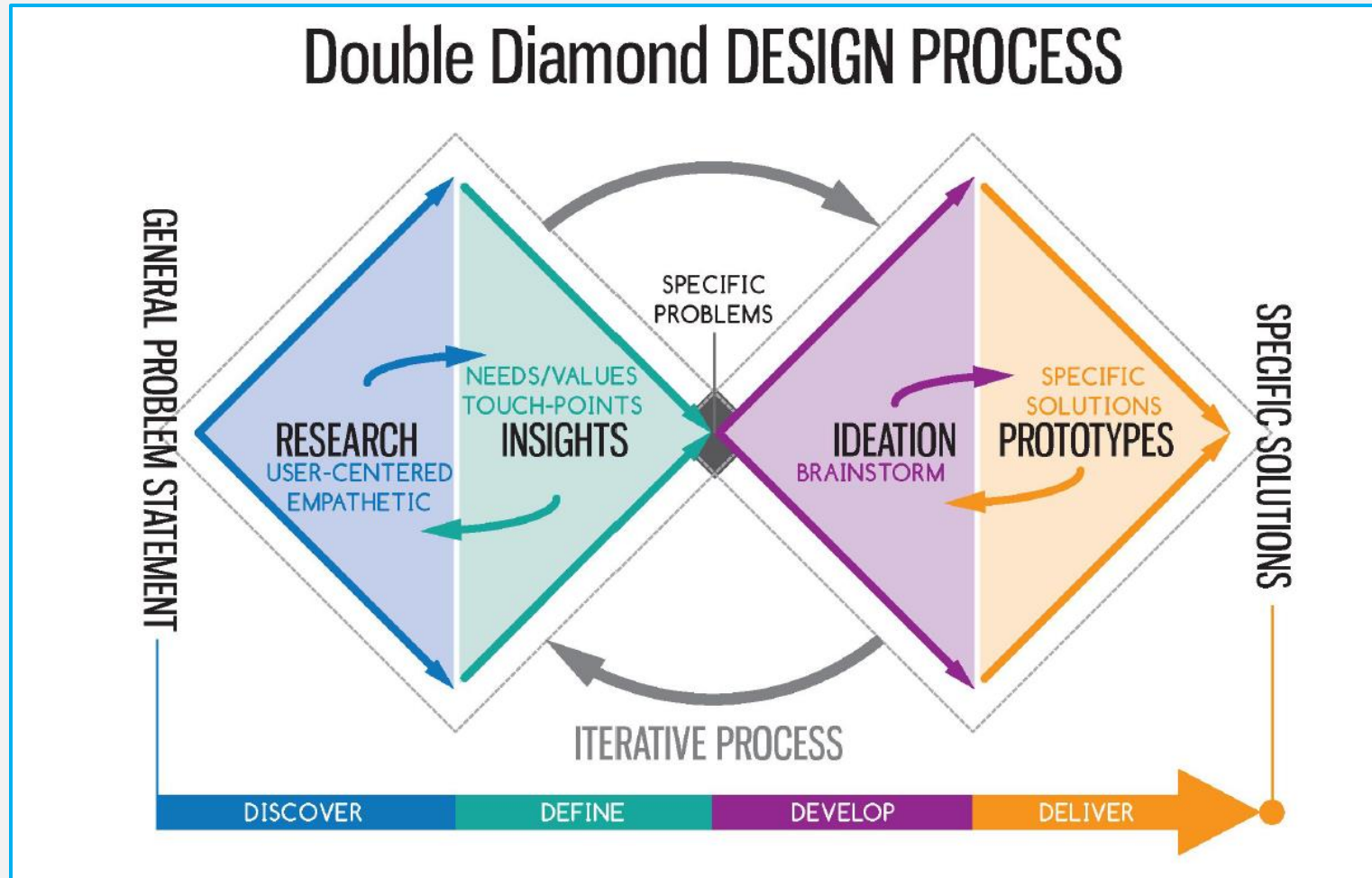

# Discovery and Ideation Workshops

**Objectives: Understand local resilience planners' needs, generate ideas for solutions to meet their needs**

- Two Discovery workshops (Oct)
  - Virtual coffee ½ hour + 3 hour workshop with breakout groups
  - 19, 12 attendees: state, local, tribal resilience planners, NGOs, academia
- EPA Regional input meeting (Dec)
  - Present discovery workshop findings
  - Discuss work in resilience, with under-resourced communities, on equity
- Ideation workshop (Dec)
  - Virtual coffee ½ hour + 3 hour workshop on 'How might we'
  - 15 attendees: state, local, tribal agencies(resilience, emergency management, libraries) foundations, NGOs, academia

# Discovery & Ideation Inform ERB Design

## Finding

1. “Resilience planning” is a broad umbrella.
2. Relationships underlie effective resilience work.
3. Under-resourced jurisdictions rely on external scientists.
4. Trauma can be a barrier to action.
5. Data “how you’re vulnerable” = frustrating. Data “helps implement action” = exciting.

## Design implication

1. Make ERB flexible to different planning contexts.
2. Encourage users to work in collaboration to use ERB.
3. Allow users to start and stop.
4. Include storytelling in ERB.
5. Include qualitative & quantitative data; “Equity review” of hazards.



# How Communities Could Use ERB

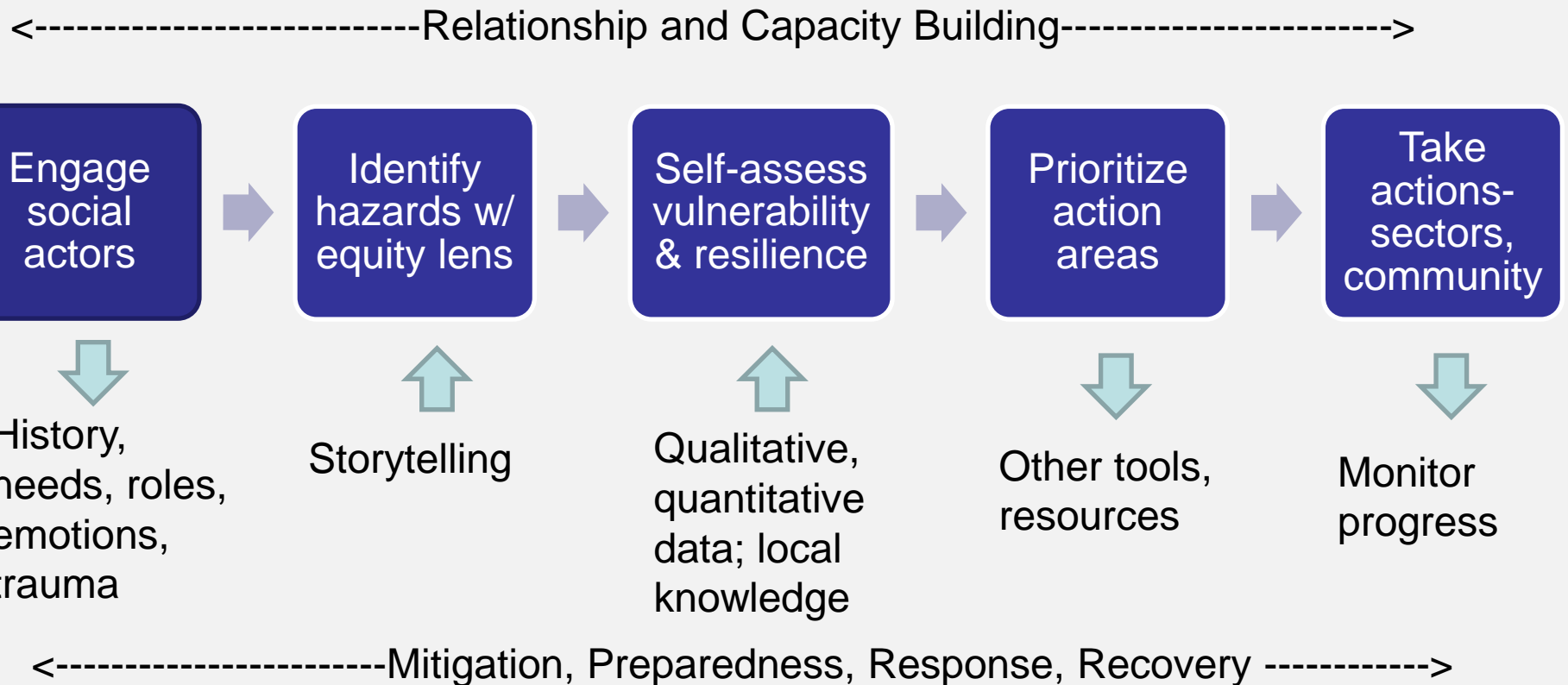

# ERB Social Vulnerability Module

- Objective:
  - Meet local jurisdictions' interest in incorporating equity and social vulnerability into resilience plans.
- Approach: Literature review
  - How and why populations and communities face differential exposure and/ or susceptibility to different hazards
  - What actions are taken

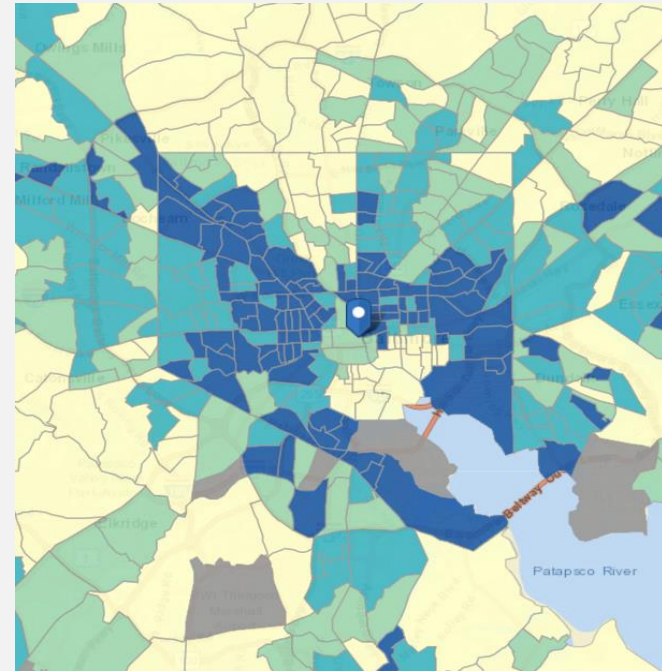

Maps show spatial patterns in vulnerability, not why/ how

<https://svi.cdc.gov>

# Social Vulnerability Framework

- Framework
  - As related to 'root causes'
  - As they experience disasters
- EXAMPLE: Experiencing flood
  - LGBTQIA individuals may face risk of violence in shelters
  - Low-wealth households may take longer to fix up flooded homes;

## Social Vulnerability

*The ways in which people and communities are vulnerable to the effects of hazards and disasters that go beyond physical exposure, including social, economic, health, cultural, and historical factors.*



## Next Steps with ERB

- Produce “paper prototype” of tool
- Test “paper prototype” with community case studies
- Develop & test “web prototype” of the tool
- Develop user guidance and training, including practices for inclusive engagement

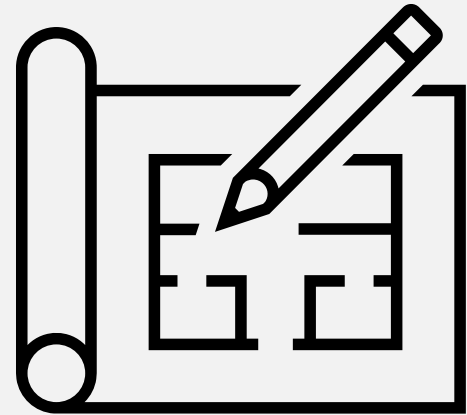

# Thank You!

We welcome opportunities for collaboration or connection with your projects.

Contact Info:

Keely Maxwell: [maxwell.keely@epa.gov](mailto:maxwell.keely@epa.gov)